

SITUATED IN THE TOWNSHIP OF CHARDON, COUNTY OF  
 GEauga AND STATE OF OHIO AND KNOW AS BEING PART OF  
 ORIGINAL CHARDON TOWNSHIP LOT No., 2, SECTION No. 1  
 TRACT No. 4. BEARINGS USED ARE BASED ON A SURVEY BY  
 ROBERT J. SMOLTZ, P.S. No. 6763 DATED SEPTEMBER 19, 2008

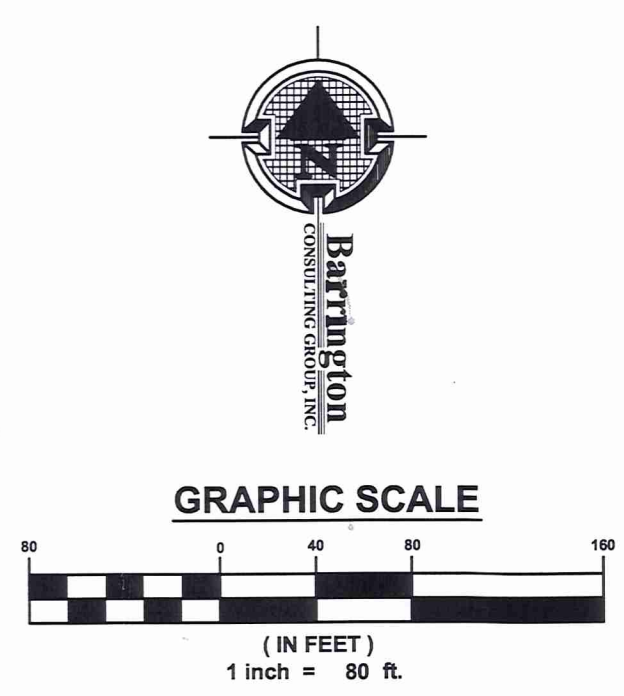

**CERTIFICATION:**  
 I HEREBY CERTIFY THAT AN ACTUAL BOUNDARY SURVEY WAS PREPARED  
 BY ME ON THE 22nd DAY OF MAY 2013, AND THAT THE SURVEY IS IN  
 ACCORDANCE WITH THE OHIO REVISED CODE CHAPTER 4733-37.  
 MINIMUM STANDARDS FOR BOUNDARY SURVEYS IN THE STATE OF OHIO.  
 PERMANENT MONUMENTS WERE FOUND, OR SET AT ALL LOCATIONS  
 SHOWN HEREON. ALL DIMENSIONS GIVEN ARE EXPRESSED IN FEET OR  
 DECIMAL PARTS THEREOF. BEARINGS ARE TO AN ASSUMED MERIDIAN  
 AND ARE SHOWN TO INDICATE ANGLES ONLY. ALL PINS SET ARE 5/8" DIA.,  
 30" LONG REBAR WITH CAP MARKED "NOVAK 7507".

I HEREBY CERTIFY THAT, THIS PLAT WAS PREPARED BY ME AND IS  
 CORRECT TO THE BEST OF MY KNOWLEDGE, INFORMATION AND BELIEF."

*David W. Novak* 5/13/2013  
 DAVID W. NOVAK, P.S. No. 7507  
 SURVEY PLAT & LEGAL DESCRIPTION  
 APPROVED PER R.C. 315.251  
 PAK 5/13/13  
 OFFICE OF THE  
 GEauga COUNTY ENGINEER



10027.LS

REVISIONS	BY

**Barrington**  
 CONSULTING GROUP, INC.  
 9114 TYLER BLYD., MENTOR, OHIO 44060  
 PHONE 440.205.1260 FAX 440.205.1262

**GEHRING**  
 Roland Gehring  
 6885 Michael Drive  
 Mentor, OH 44060  
 216.272.6976

**LOT SPLIT**  
 10033 LITTLE MOUNTAIN ROAD, CHARDON TWP., OH 44024  
 PPN 09-001514  
**GEHRING**

DRAWN WSO
CHECKED DWN
DATE MAY 30 2013
SCALE 1"=80'
JOB NO. 10027.LS
SHEET
OF SHEETS

13-043-001.DWG 07/11/2013 10:28:13 AM 20080513 10:28:13 AM Copyright Barrington Consulting Group

CHA 00165

CHA00165

GEHRing (13-043)  
Picked up date  
5-31-13  
09-001542  
VOL 1958 PG 671

### Parcel 1

Situated in the township of Chardon, County of Geauga and State of Ohio and know as being part of Original Chardon Township Lot No., 2, Section No. 1 Tract No. 4 and being further bounded and described as follows:

Beginning at a monument with a drill hole found at the intersection of the centerline of Little Mountain Road, 60 feet wide and the centerline of King Memorial Road;

Thence N 89°09'40" E, 3119.13 feet along said centerline of Little Mountain Road to the northeast corner of a parcel of land owned by Gregory C. Sarkisian (PPN 09-001516), recorded deed, Volume 1850, Page 2526, Geauga County Record of Deeds, said point also being the principal place of beginning, said centerline also being the dividing line between Geauga County, Chardon Township and Lake County, Concord Township;

Thence N 89°09'40" E, 60.00 feet along continuing along said centerline of Little Mountain Road to a point;

Thence S 00°17'05" E, (passing through a capped 5/8" iron pin set at 30.00 feet ) 1203.77 feet to a capped 5/8" iron pin set;

Thence N 89°09'40" E, 696.24 feet to a capped 5/8" iron pin set on the west line of a parcel of land owned by Robert D. and Nancy B. Searles (PPN 09-001526), recorded deed, Volume 1853, Page 3315, Geauga County Record of Deeds;

Thence S 09°48'12" E, 182.46 feet continuing along said Searles' west line to a capped (S.H. & A) 5/8" iron pin found;

Thence S 08°39'40" E, 332.08 feet continuing along said Searles' west line to a 5/8" iron pin found at the northeast corner of a parcel of land owned by James A. Victor (PPN 09-001541), recorded deed, Volume 1906, Page 3460, Geauga County Record of Deeds;

Thence N 81°54'02" W, 843.77 feet along said Victor's north line to capped (unreadable) 5/8" iron pin found at said Sarkisian's southeast corner;

Thence N 00°17'05" W, (passing through a capped (Dudley) 5/8" iron pin found at 1551.91 feet) 1581.91 feet along said Sarkisian's east to the principal place of beginning;

and containing 9.7155 acres (0.0413 acres of within the right of way of said Little Mountain Road) of land be the same more or less but subject to all legal highways, and easements of record as surveyed and described May, 2013 by David W. Novak, P.S. No. 7507. Bearings used are based on a survey by Robert J. Smoltz, P.S. No. 6763 dated September 19, 2008 and used to denote angular relationship only and do not represent true north. The intent of this survey is to split 9.7155 acres from PPN 09-001514.

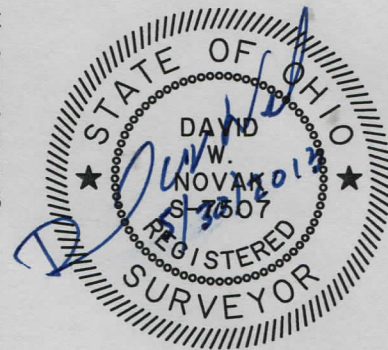

W:\2010\10027\LOT SPLIT\Parcel 1 Legal 20130530.doc, 5.30.2013

SURVEY PLAT & LEGAL DESCRIPTION  
APPROVED PER R.C. 315.251

PAK 5/31/13

OFFICE OF THE Re  
GEAUGA COUNTY ENGINEER

### Parcel 2

Situated in the township of Chardon, County of Geauga and State of Ohio and know as being part of Original Chardon Township Lot No., 2, Section No. 1 Tract No. 4 and being further bounded and described as follows:

Beginning at a monument with a drill hole found at the intersection of the centerline of Little Mountain Road, 60 feet wide and the centerline of King Memorial Road;

Thence N 89°09'40" E, 3179.13 feet along said centerline of Little Mountain Road to the principal place of beginning, said centerline also being the dividing line between Geauga County, Chardon Township and Lake County, Concord Township;

Thence N 89°09'40" E, 557.14 feet continuing along said centerline of Little Mountain Road to the northwest corner of a parcel of land owned by Robert D. and Nancy B. Searles (PPN 09-001526), recorded deed, Volume 1853, Page 3315, Geauga County Record of Deeds;

Thence S 04°33'17" E, (passing through a capped (S.H. and A) 5/8" iron pin found at 30.06 feet) 674.16 feet along said Searles' west line to a capped (S.H. and A) 5/8" iron pin found;

Thence S 09°48'12" E , 537.54 feet continuing along said Searles' west line to a capped 5/8" iron pin set;

Thence S 89°09'40" W, 696.24 feet to a capped 5/8" iron pin set;

Thence N 00°17'05" W, (passing though a capped 5/8" iron pin set at 1173.77 feet) 1203.77 feet to the principal place of beginning;

and containing 16.9371 acres (0.3845 acres of within the right of way of said Little Mountain Road) of land be the same more or less but subject to all legal highways, and easements of record as surveyed and described May, 2013 by David W. Novak, P.S. No. 7507. Bearings used are based on a survey by Robert J. Smoltz, P.S. No. 6763 dated September 19, 2008 and used to denote angular relationship only and do not represent true north. The intent of this survey is to split 16.9371 acres from PPN 09-001514.

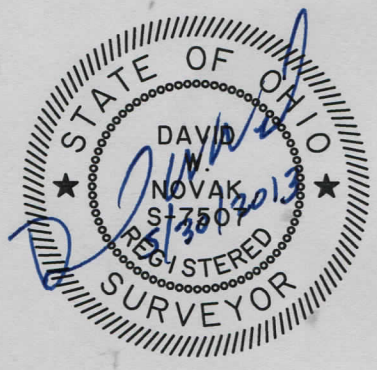

SURVEY PLAT & LEGAL DESCRIPTION  
APPROVED PER R.C. 315.251

PAK 5/31/13

OFFICE OF THE *Rev*  
GEAUGA COUNTY ENGINEER